

Parts list COMBISTAR 2000-A/PT GLRD

Mechanical seal

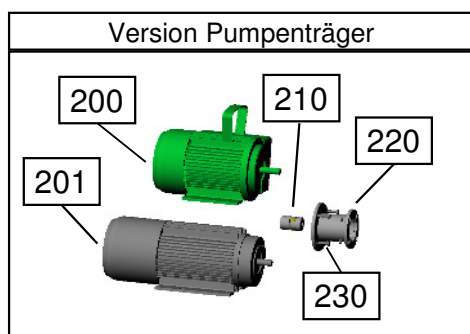
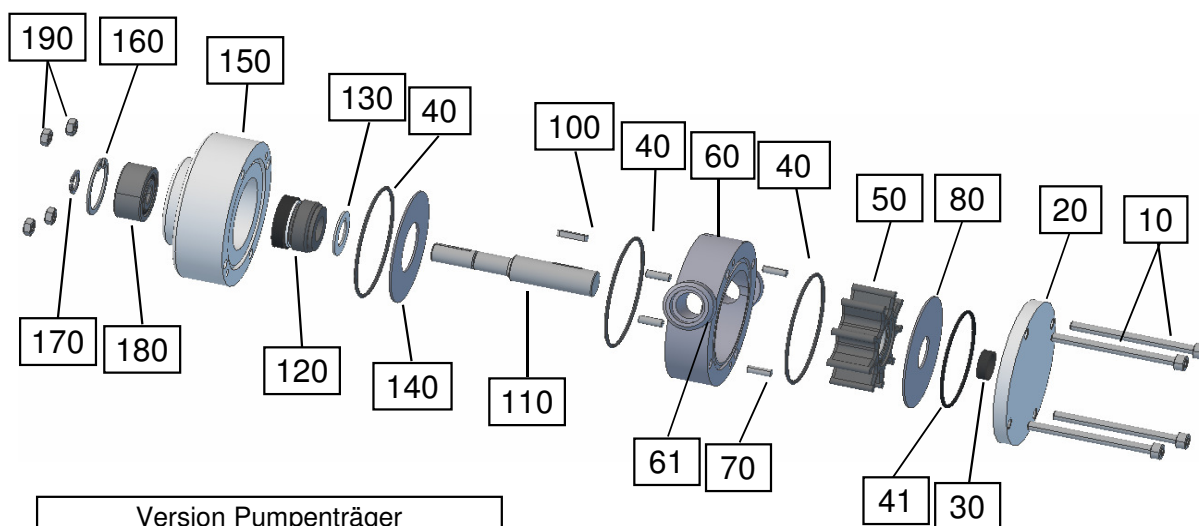

Parts list

Pos.:	Part / Designation	Code	Number
10	Cylinder head screw with hexagon socket M 5x70	70322	4
20	Front cover COMBISTAR-Gleitlager	11012602GL	1
30	Plain bearings Igluor XSN	141606	1
40	O-Ring 56-2 NBR	80003	3
40	O-Ring 56-2 EPDM	80151	3
40	O-Ring 56-2 VITON	80150	3
41	O-Ring 54-2 NBR	800054N	1
41	O-Ring 54-2 VITON	800054V	1
50	Impeller Perbunan type A / polyamid bush	11012909	1
50	Impeller Perbunan type A / stainless steel bush	11012908	1
50	Impeller Perbunan type A / stainless steel special bush	110129081	1
50	Impeller Neoprene type A / stainless steel bush	11012505	1
50	Impeller Neoprene type A / stainless steel special bush	110125051	1
50	Impeller EPDM type A / stainless steel bush	11012401	1
50	Impeller EPDM type A / stainless steel special bush	110124011	1
50	Impeller EPDM type A / polyamid bush	11012402	1
50	Impeller VITON type A / stainless steel bush	11012801	1
50	Impeller VITON type A / polyamid bush	11012810	1
50	Impeller VITON type A / polyamid special bush	110128011	1
50	Impeller plastic type A / polyamid bush	11012301	1
60	Housing NIROSTAR A with threaded nipple	11012601	1
61	Threaded nipple Combi/Nirostar A	11012604	2
70	Dowel 4x12 stainless steel	70268	4

Parts list

Pos.:	Part / Designation	Code	Number
80	Wear plate with punched hole - stainless steel	11012709	1
100	Fitting key A3x3x16	70315	1
110	Shaft short 10mm PT/GLRD	11012005PT-GLRD	1
120	Mechanical seal Carbon/Ceramik/FKM	165000	1
120	Mechanical seal Carbon/Ceramik/EPDM	165000E	1
130	Distance disk mechaical seal	110127092	1
140	Lateral disk with hole mechanical seal	110127091	1
150	Rear cover COMBISTAR 2000A/PT-GLRD	11013904PT-GLRD	1
160	Locking ring I 30x1,2 A2	70305	1
170	Locking ring A10	70307	1
180	Ball bearings 4200 2RS	800017	1
190	Hex nut M5 stainless steel	70003	8
200	Motor 230V; 0,37 KW; 1400 U;	80609	1
200	Motor 230V; 0,37 KW; 2800 U;	80608	1
200	Motor 230V; 0,37 KW; 2800 U; L/R run	80608LR	1
200	Motor 400V; 0,37 KW; 1400 U;	80615	1
200	Motor 400V; 0,37 KW; 2800 U;	80613	1
201	Motor 12V-DC; 0,25 KW; 1500 U;	80099CEM	1
201	Motor 12V-DC; 0,25 KW; 3000 U;	80101CEM	1
201	Motor 24V-DC; 0,25 KW; 1500 U;	80098CEM	1
201	Motor 24V-DC; 0,25 KW; 3000 U;	80100CEM	1
210	Rotex coupling complete	141026	1
220	Pump adapter	12000101	1
230	Hexagon socket head cap screw M6x16	70055	4